



BRUSHES

TUBE | HONING | DISC | CUP | ROLLER | CERAMIC | WHEEL





BRUSHES



TUBE BRUSH

Material can also use:

Copper: has good electrical conductivity and plasticity, but its strength and hardness are poor. Copper has excellent thermal conductivity, ductility and corrosion resistance. Trace impurities in copper have a serious impact on the conductivity and thermal conductivity of copper.

Carbon steel: also called carbon steel, refers to iron-carbon alloys with a carbon content W_c less than 2.11%. Carbon steel generally contains a small amount of silicon, manganese, sulfur, phosphorus in addition to carbon. The carbon content of carbon steel is generally higher. The higher the hardness, the higher the strength, the lower the plasticity.

Stainless steel: silver-white, iron alloy, melting point 1398-1454 °C, good corrosion resistance, heat resistance, low temperature strength and mechanical properties; good hot workability such as stamping and bending, no heat treatment hardening (Use temperature - 196 °C ~ 800 °C), corrosion resistance in the atmosphere.

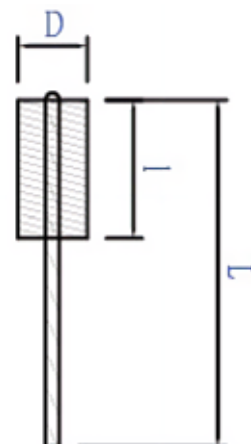

Silicon carbide, alumina, nylon, copper-plated steel wire, brass wire, stainless steel wire, flame-retardant steel wire, etc.

Tube Brush parameters

Overall Diameter (D)	Brush Length (l)	Total Length (L)	Optional brush material	Rotating speed
Φ2	30	90	Silicon carbide, alumina, nylon, copper-plated steel wire, brass wire, stainless steel wire, flame-retardant steel wire, etc.	800 - 2000
Φ3	30	90		
Φ4	30	90		
Φ5	35	120		
Φ6	35	120		
Φ8	40	150		
Φ10	40	150		
Φ12	40	150		
Φ14	40	150		
Φ16	50	150		
Φ18	50	150		
Φ20	80	200		
Φ22	80	200		
Φ24	80	200		

Tube Brush parameters

Overall Diameter (D)	Brush Length (l)	Total Length (L)	Optional brush material	Rotating speed
Φ8	30	100	Silicon carbide, alumina, nylon, copper-plated steel wire, brass wire, stainless steel wire, flame-retardant steel wire, etc.	800 - 2000
Φ10	30	100		
Φ12	30	100		
Φ14	35	120		
Φ16	35	120		
Φ18	40	150		
Φ20	40	150		
Φ22	40	150		
Φ24	40	150		
Φ26	50	150		
Φ28	50	150		
Φ30	80	200		
Φ32	80	200		
Φ34	80	200		

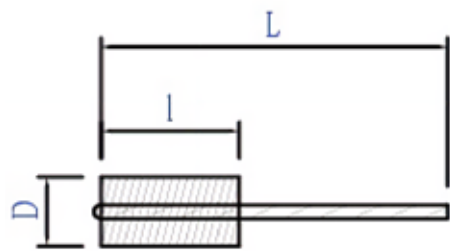

TUBE BRUSH

Material can also use:

Silicon carbide: Mixing quartz sand, petroleum coke (or coal char), wood chips (requires salt when producing green silicon carbide) and other raw materials smelted by electric furnace at high temperature. it has high thermal conductivity, small thermal expansion coefficient and good wear resistance.

Alumina Oxide: mainly used for grinding (slight), polishing, deburring, textile sanding, etc., wherein the high temperature resistance is mainly used for products with higher technical requirements and higher temperature scenes.

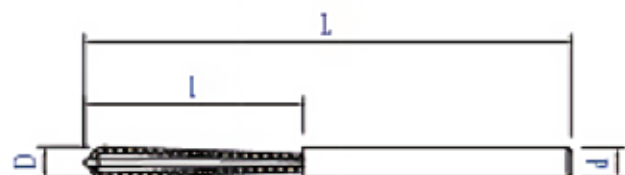
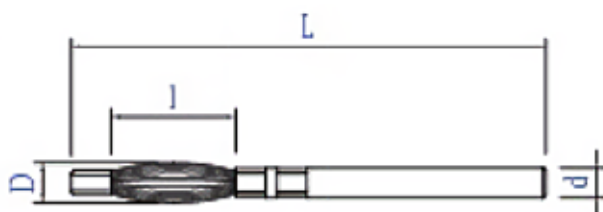

Tube Brush parameters

Overall Diameter (D)	Brush Length (l)	Total Length (L)	Optional brush material	Rotating speed
Φ2	30	90	Stainless steel wire, copper plated multi-strand wire	1000
Φ3	30	90		
Φ4	30	90		
Φ5	35	120		
Φ6	35	120		
Φ8	40	150		
Φ10	40	150		
Φ12	40	150		
Φ14	40	150		
Φ16	50	150		
Φ18	50	150		
Φ20	80	200		
Φ22	80	200		
Φ24	80	200		

END BRUSH

Introduction /use:

It is a mistake: "brush is longer, the softness is better, and the durability should be longer and better". In fact, because the real working part in the polishing process is not the tangent plane of the filament, but the side of the filament, the length of the filament is increased, and the amplitude (angle) of each filament is also increased greatly, at 800-2500 pm. Under the condition of minute, the internal stress and fatigue coefficient of the brush root will be multiplied, resulting in the abrasive filament being easily broken and the filament being obviously deformed. It is understandable to use coarser abrasive grains in order to enhance the cutting force.

However, in the case of small particle size change, the effect of simply thickening the abrasive is almost negligible. On the contrary, there may be some negative effects. Because the brush will oscillate when working, the abrasive will produce a shear on the brush itself. The greater the angle of the brush swing, the more obvious the test proves.

Used to remove debris, marks, burrs and rust that are not easily accessed Can be equipped on power tools or hand tools for high efficiency, low cost and flexibility.

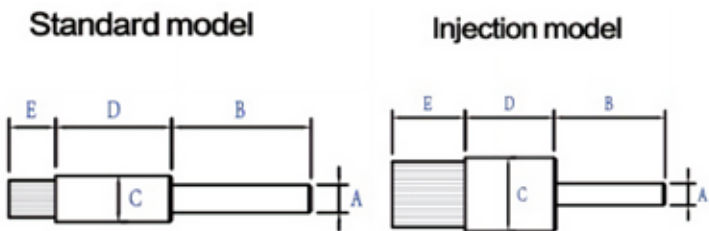

Standard model parameters

Handle Diameter A*B	Brush Diameter C*D	Brush Length (E)	Optional brush material	Rotating speed
Φ4*30	Φ6*25	10	Silicon carbide, alumina, nylon, copper-plated steel wire, brass wire, stainless steel wire, flame-retardant steel wire, etc	1500
Φ6*30	Φ8*25	10		
Φ6*30	Φ10*25	10		
Φ6*30	Φ12*25	10		
Φ6*30	Φ15*25	10		



Injection model parameters

Handle Diameter A*B	Brush Diameter C*D	Brush Length (E)	Optional brush material	Rotating speed
Φ6*30	Φ16*25	25	Silicon carbide, alumina, nylon, copper-plated steel wire, brass wire, stainless steel wire, flame-retardant steel wire, etc	1500
Φ6*30	Φ20*25	25		
Φ6*30	Φ25*25	25		
Φ6*30	Φ28*25	25		

HONING BRUSH

Introduction

A whetstone is a resilient, flexible sanding tool that finishes sanding in a relatively soft manner. Its unique construction floats its sanding ball, which ensures that the tool can control the center and self-adjust itself while machining the hole, and can offset the wear by itself. filament during the produc-tion, so that the folded steel wire is even asymmetrical.

Use

The whetstone tool removes the ridges and other ridges from the barrel wall to create a satisfactory surface finish. Therefore, the surface treated with soft whetstone can reduce local overheating or excessive friction, resulting ni better quality parts.

Suitable for deburring and polishing different mechanical parts parts such as nyardune notes, nyardune vaives, broken nammers, tic. Clean up burrs, rust removal, internal cleaning of keyways and grooves, etc.



Honing Brush parameters

Overall Diameter (D)	Brush Length (l)	Total Length (L)	Optional brush material	Rotating speed
Φ6	50	200	Silicon carbide, Alumina	1200
Φ8	50	200		
Φ10	50	200		
Φ15	50	200		
Φ20	50	200		
Φ30	70	200		
Φ40	70	200		
Φ50	70	200		
Φ80	70	200		
Φ100	70	300		
Φ120	80	300		
Φ130	80	300		
Φ150	100	300		
Φ180	100	300		

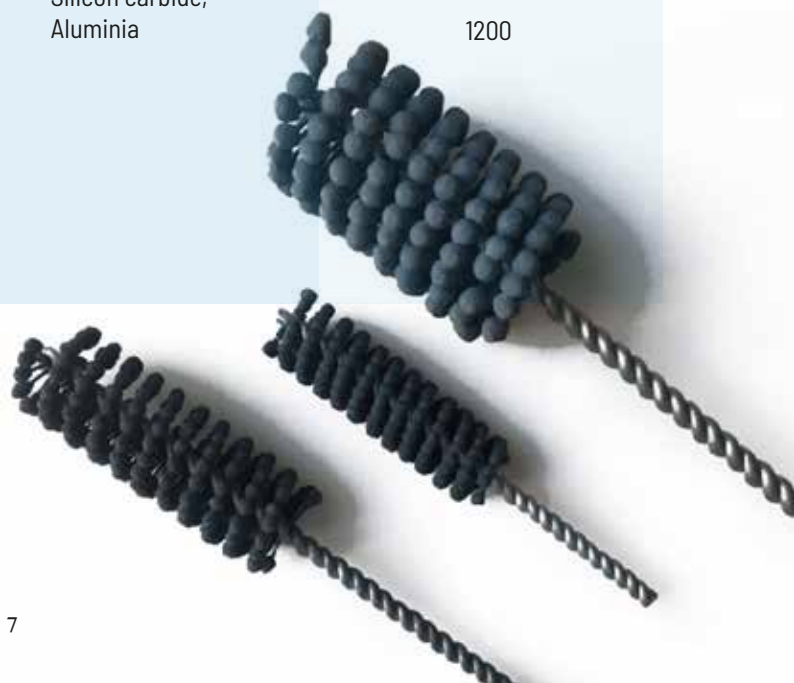

DISC BRUSH

Introduction /use:

Suitable for surface treatment or work-pieces. Surface treatment or different industries such as automotive hydraulic parts, etc. Brush should not fall off during work. The brush wire in the brush base should be fixed with high-strength stainless steel to prevent rust. Use wavy curved brush. The grinding sand in the brush wire should not fall off due to the bending or the brush wire.

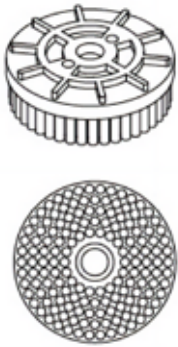
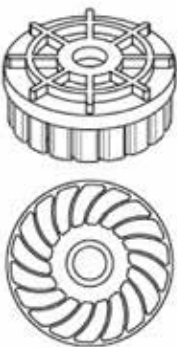

Reasonable brush height and density.
The brush wire should have high hardness and toughness in a humid environment.

The brush should have good bending recovery.
The brush should have good wear resistance.



Spiral surface parameters

Overall Diameter	Inner hole Diameter	Brush Length L	Optional brush material	Rotating speed
Φ125	Φ25*35	31mm	Silicon carbide, alumina	2000

Straight hole surface

Overall Diameter	Inner hole Diameter	Brush Length L	Optional brush material	Rotating speed
Φ125	Φ25*35	31mm	Silicon carbide, alumina	2000

DISC BRUSH WITH POLE

Introduction /use:

It has been said that many brush manufacturers believe that the thicker wire diameter can increase the hardness and enhance the cutting force. This is not the case, because the true high-quality abrasive wire has an optimum balance between hardness and flexibility: the right hardness gives the product a good rigidity, good contact and grinding of the work piece; suitable flexibility makes the brush have Good resilience, which not only ensures the machining accuracy of the workpiece surface, but also reduces the wear and internal stress during the brush grinding operation, thus improving the service life of the brush without broken wires.



Disc Brush (Straight hole with rod)

Overall Diameter (D)	Brush Holder diameter d*I (mm)	Total Length (L)	Optional brush material	Rotating speed
Φ35	Φ8*50	25	Silicon carbide, alumina, nylon, copper-plated steel wire, brass wire, stainless steel wire, flame-retardant steel wire, etc	2000
Φ45	Φ8*50	25		
Φ55	Φ8*50	25		
Φ65	Φ12*60	25		
Φ75	Φ12*60	25		
Φ85	Φ12*60	25		
Φ105	Φ12*60	25		



Disc Brush (Straight hole with rod)

Overall Diameter (D)	Brush Holder diameter d*I (mm)	Total Length (L)	Optional brush material	Rotating speed
Φ125	Φ25*35	31	Silicon carbide, alumina, nylon, copper-plated steel wire, brass wire, stainless steel wire, flame-retardant steel wire, etc	2000

ROD FLAT BRUSH (PIECE)

Material can also use:

Bristles: taken from the pig, from the root to the end, from coarse to fine, this feature makes the bristles elastic. Just like the end of the hair will be slightly, bifurcated; the common Bristle is brown (white) or black, and has excellent durability and water resistance. Naturally, Bristles can also prevent electricity, resist high temperature acid and alkali.

Horse tail: longer than horsehair and has stronger hardness. It has the characteristics of long fiber length, strong pulling force, wear resistance and humidity resistance, and it is not easy to break.

Wool: soft and elastic. Won't leave brush mark after use. In addition to being made into a paint brush, wool is commonly used on short, soft brushes, such as makeup brushes.

Horse hair: its softness is between bristle and wool, horsetail hair will be slightly harder than bristle; has good toughness and wear resistance, but it is not resistant to acid and alkali. Usually brush is used for polishing, cleaning and dust removal. And other related industries; the brush with horse hair is resistant to high temperatures of around 190 degrees Celsius.



Winding rod flat parameters

Inner chip diameter	Cover diameter	Overall diameter (D)	Brush diameter (L)	Optional brush material	Rotating speed
Φ6	Φ20	Φ30-Φ40	6-	Silicon carbide, alumina, nylon, copper-plated steel wire, brass wire, stainless steel wire, flame-retardant steel wire, etc	1000
Φ12	Φ33	Φ35-Φ60	6-		
Φ18	Φ36/Φ46	Φ65-Φ70	7-		
Φ27	Φ55/Φ60	Φ85-Φ100	8-		
Φ44	Φ70/Φ80	Φ115-Φ135	10-		
Φ53	Φ84/Φ103	Φ140-Φ150	11-		
Φ70	Φ115	Φ160-Φ200	10-		
Φ83	Φ120/Φ140	Φ180-Φ220	11-		
Φ103	Φ140/Φ160	Φ200-Φ250	12-		
Φ137	Φ200	Φ250-Φ300	12-		



ROD FLAT BRUSH(WINDING)

Introduction

The thickness of the wire can be determined according to different needs. Straight wire and curved wire. Straight wire is suitable for drilling and planing methods, such as wood wire brush, wooden handle wire brush etc.; and the application range of the wire is basically every type of wire brush can be used, if the straight wire is used, it is impossible to standardize and tidy after the steel wire is folded. The curved wire can be relatively matched with the nearby filament during the production, so that the folded steel wire is even asymmetrical.

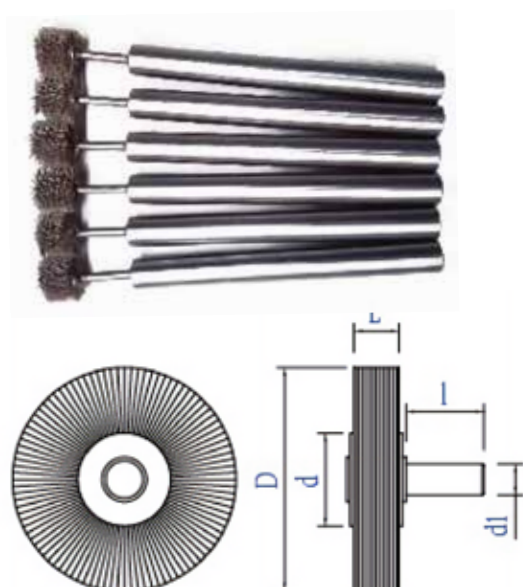

Use

Suitable for drilling burs, polishing, descaling, internal cleaning of keyways and grooves, deburring, internal holes, blind holes, cross holes, etc. Different level of roughness and grinding force can be carried out with suitable materials within certain amount of time



Winding rod flat parameters

Inner chip diameter	Cover diameter	Overall diameter (D)	Brush diameter (L)	Optional brush material	Rotating speed
Φ6	Φ20	Φ30-Φ40	6-	Silicon carbide, alumina, nylon, copper-plated steel wire, brass wire, stainless steel wire, flame-retardant steel wire, etc	1000
Φ12	Φ33	Φ35-Φ60	6-		
Φ18	Φ36/Φ46	Φ65-Φ70	7-		
Φ27	Φ55/Φ60	Φ85-Φ100	8-		
Φ44	Φ70/Φ80	Φ115-Φ135	10-		
Φ53	Φ84/Φ103	Φ140-Φ150	11-		
Φ70	Φ115	Φ160-Φ200	10-		
Φ83	Φ120/Φ140	Φ180-Φ220	11-		
Φ103	Φ140/Φ160	Φ200-Φ250	12-		
Φ137	Φ200	Φ250-Φ300	12-		

STRIP BRUSH

Material can also use:

Nylon 6: Decent cost, with excellent recovery, temperature and wear resistance, low melting point and wide process temperature range. Its stress resistance and solubility are better than nylon 66 plastic, but it is also more hygroscopic.

Nylon 66 (PA66): Compared with nylon 6, nylon 66 has a slightly higher hardness, recovery and wear resistance at the same wire diameter, and its temperature resistance can reach 150 degrees Celsius.

Nylon 610 (PA610): has low density, its water absorption is lower than nylon 66 (PA66) and nylon 6 (PA6). It has good dimensional stability and easy molding. The mechanical strength is close to PA66 and PA6. It is resistant to strong alkali and is more resistant to ordinary weak acids than double 6 and single 6, but soluble in formic acid.

Nylon 612 (PA612): a relatively high quality nylon yarn with low water absorption and better recovery and wear resistance than nylon 66. It has anti-mold and anti-bacterial properties, and its brush wheel and brush strip are often used in food, medical and electronics related industries. Application: Ultra-fine, able to maintain verticality in hot water with a certain temperature and very dry, not easy to bend, high stability

Nylon 1010 (PA1010): Translucent, light and hard, bright-colored crystalline white or yellowish particles, relatively low density and water absorption than nylon 6 and nylon 66, cold resistance better than nylon 6, low cost and good economic effect Excellent

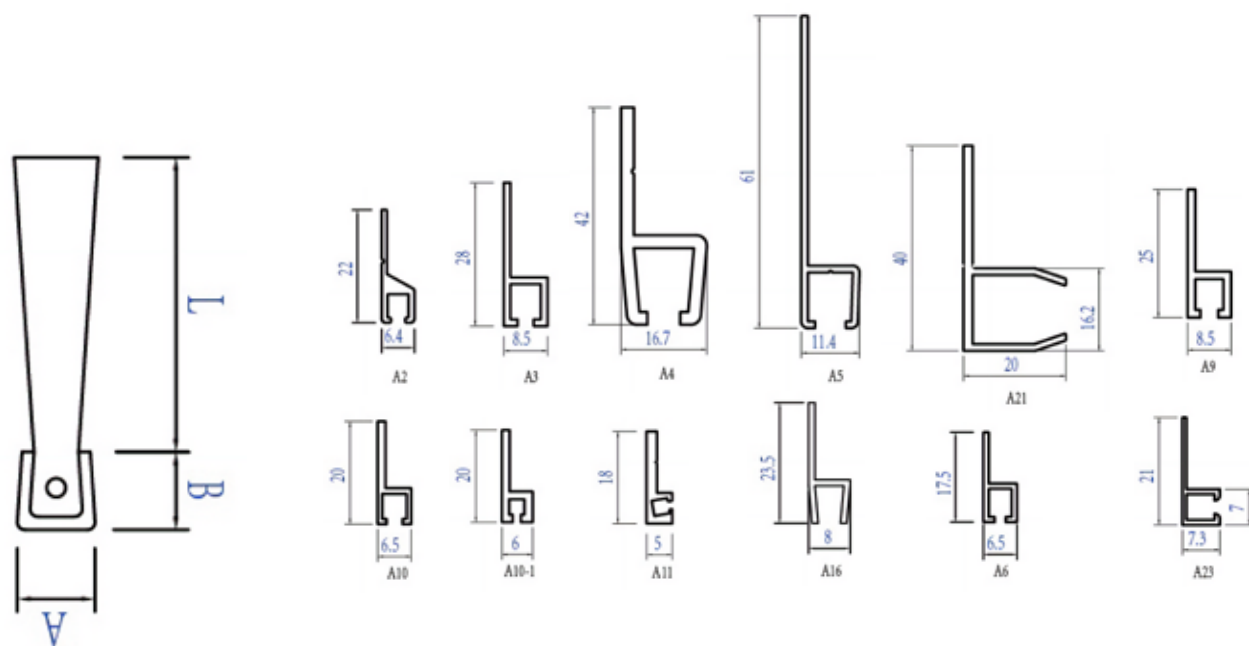

Single steel strip parameters



Standard size A*B (mm)	Brush Length L (mm)	Horizontal length	Optional brush material
Φ35	Φ8*50	5-2000(mm) (Can be customized according to requirements)	Silicon carbide, alumina, nylon, copper-plated steel wire, brass wire, stainless steel wire, flame-retardant steel wire, etc
Φ45	Φ8*50		
Φ55	Φ8*50		
Φ65	Φ12*60		
Φ75	Φ12*60		
Φ85	Φ12*60		
Φ105	Φ12*60		

DOUBLE STEEL STRIP BRUSH

Introduction /use:

Double strip brushes are widely used in various types of automatic doors, movable doors and windows, revolving doors, smooth doors, elevator seals to block dust, prevent dust from entering the interior, and large industrial machinery cleaning, glass edger water retaining, agricultural harvesting Internal seal, wind turbine cover seal, car washer brush, etc.

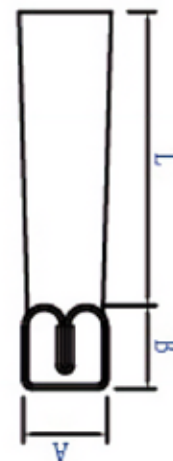

Parallel steel strip parameters

Overall Diameter (D)	Brush Holder diameter d* _l (mm)	Horizontal length	Optional brush material
8*8	60-80	5-2000 (mm) (Can be customized according to requirements)	Silicon carbide, alumina, nylon, copper-plated steel wire, brass wire, stainless steel wire, flame-retardant steel wire, etc
10*10	80-200		

INNER WINDING BRUSH

Introduction

Including: Sealing strip brush, iron strip brush, stainless steel strip brush, horse hair brush, stainless steel wire brush, corrugated nylon wire brush, brick machine brush, nylon wire brush, etc. The product si extended, that is, the brush strip is spirally wound on the processed steel shaft, and the two ends are welded and fixed, and the brush is dense and does not fall off. The hollow core spring brush can be installed and replaced by the customer according to the size, and the use cost si lower.

Use

The brush shaft can be made of 45# round steel, ordinary stainless steel and 304# stainless steel. Depending on the application, the brush can be made of sisal, wool, P wire, steel wire, stainless steel wire, copper plated wire, copper wire, abrasi-ve wire, etc.

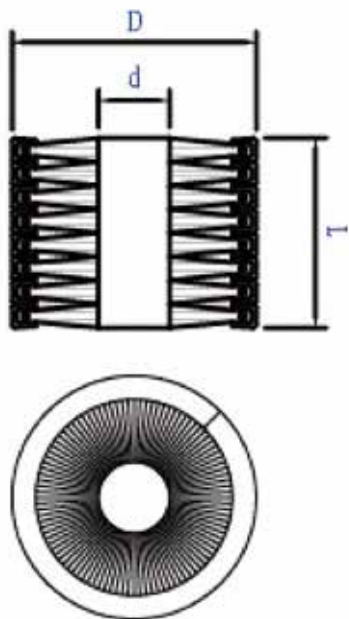

Inner winding parameters

Inner Diameter (d)	Outer Diameter (D)	Overall Length (L)	Optional brush material	Rotating speed
Φ3	Φ20	3-	Silicon carbide, alumina, nylon, copper-plated steel wire, brass wire, stainless steel wire, flame-retardant steel wire, etc	800-1800
Φ4	Φ30	5-		
Φ5	Φ40	6-		
Φ6	Φ45	8-		
Φ8	Φ50	10-		
Φ10	Φ60	10-		
Φ15	Φ70	10-		
Φ20	Φ80	10-		
Φ30	Φ100	10-		
Φ50	Φ100	10-		

OUTER WINDING BRUSH

Introduction

Including: Sealing strip brush, iron strip brush, stainless steel strip brush, horse hair brush, stainless steel wire brush, corrugated nylon wire brush, brick machine brush, nylon wire brush, etc. The product is extended, that is, the brush strip is spirally wound on the processed steel shaft, and the two ends are welded and fixed, and the brush is dense and does not fall off. The hollow core spring brush can be installed and replaced by the customer according to the size, and the use cost is lower.

Use

The brush shaft can be made of 45# round steel, ordinary stainless steel and 304# stainless steel. Depending on the application, the brush can be made of sisal, wool, P wire, steel wire, stainless steel wire, copper plated wire, copper wire, abrasive wire, etc.

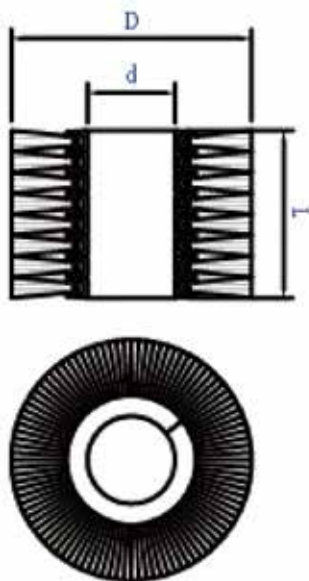

Outer winding parameters

Inner Diameter (d)	Outer Diameter (D)	Overall Length (L)	Optional brush material	Rotating speed
Φ0	Φ20	3-	Silicon carbide, alumina, nylon, copper-plated steel wire, brass wire, stainless steel wire, flame-retardant steel wire, etc	800-1800
Φ3	Φ30	5-		
Φ4	Φ40	6-		
Φ5	Φ45	8-		
Φ6	Φ50	10-		
Φ8	Φ60	10-		
Φ10	Φ70	10-		
Φ15	Φ80	10-		
Φ20	Φ100	10-		
Φ30	Φ100	10-		

CUP BRUSH

Introduction /use:

Abrasive wire brush: mainly used in steel mills or other hardware industries, used for cleaning and rusting of steel plates, deburring and polishing of other castings, steel strips, aluminum strips, copper strips, etc.



Cup Brush parameters

Overall Diameter (D)	Overall Diameter (L)	Horizontal lenght	Optional brush material
Φ110	120	Metalic Wire, abrasive wire	1000 - 3000
Φ80	100		
Φ50	70		
Φ30	60		
Φ22	45		



ROLLER BRUSH

Introduction

The brush roller is generally composed of a metal shaft, a wire attachment body (a plastic tube, a nylon tube, etc.), and a brush wire. Processing procedures include: axles, casing (casting), eye collection, planting, flat hair. For the special shaped brush roller, the wool is manually plant- ed in the case where the planting hair cannot be finished.

Use

There are 5 kinds of industries suitable for brush roller: food processing industry, glass ceramic industry, metal processing industry, polishing and cleaning industry, textile machinery. It is possible to produce a brush roller suitable for any production line requirements and environment.



Brush roller parameters

Overall Diameter	Shaft size	Brush Length	Optional brush material
Custom made	Custom made	Custom made	Steel wire, stainless steel wire, abrasive wire



Flaky brush roller



Injection brush roller

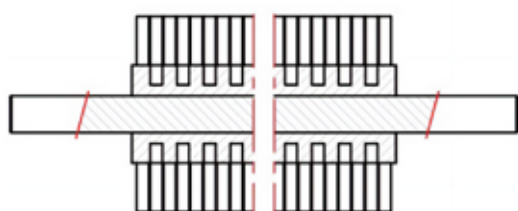

Winding brush roller

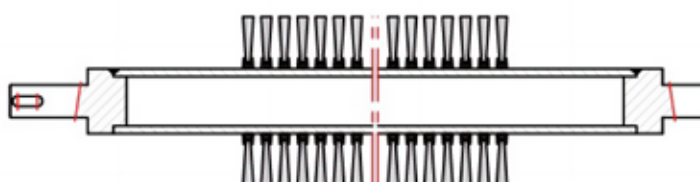

CERAMIC FIBER BRUSH

Introduction / use

Ceramic fiber is a kind of fibrous lightweight refractory material with light weight, good thermal insulation performance, good thermal stability, good chemical stability, easy processing and convenient construction. However, It is neither wear-resistant nor resistant to collision, and can not resist the erosion of high-speed airflow, or the erosion of slag.

End brush Ceramic fiber parameter

Overall Diameter (D)	Overall Diameter (L)	Optional brush material	Rotating speed
Φ15	70	Ceramic fiber	2000 - 4000
Φ12	60		
Φ10	50		
Φ8	40		
Φ6	30		

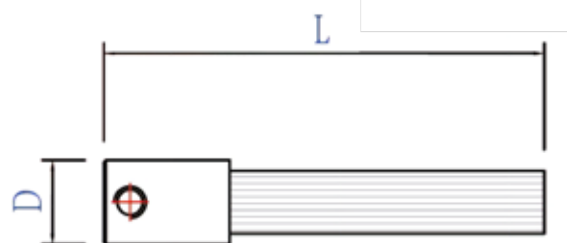

Disc brush Ceramic fiber parameter

Overall Diameter (D)	d	Overall Diameter (L)	Optional brush material	Rotating speed
Φ125	Φ17	100	Ceramic fiber	2000 - 4000
Φ100	Φ14	100		
Φ80	Φ12	100		
Φ60	Φ10	90		
Φ40	Φ8	80		
Φ20	Φ6	65		

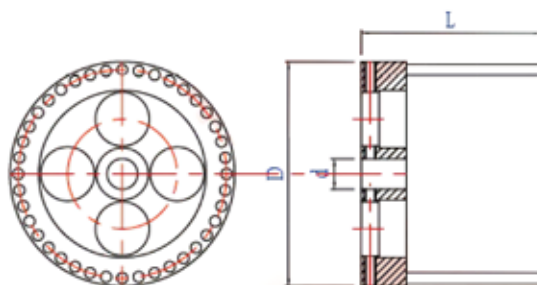

CERAMIC FIBER BRUSH

Introduction / use

Including: Sealing strip brush, iron strip brush, stainless steel strip brush, horse hair brush, stainless steel wire brush, corrugated nylon wire brush, brick machine brush, nylon wire brush, etc. The product is extended, that is, the brush strip is spirally wound on the processed steel shaft, and the two ends are welded and fixed, and the brush is dense and does not fall off. The hollow core spring brush can be installed and replaced by the customer according to the size, and the use cost is lower.

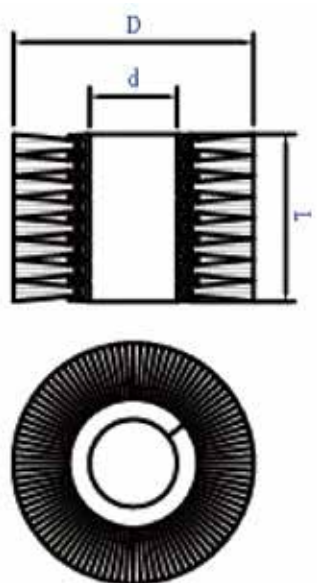

Outer winding parameters

Inner Diameter (d)	Outer Diameter (D)	Overall Length (L)	Optional brush material	Rotating speed
Φ0	Φ20	3-	Silicon carbide, alumina, nylon, copper-plated steel wire, brass wire, stainless steel wire, flame-retardant steel wire, etc	800-1800
Φ3	Φ30	5-		
Φ4	Φ40	6-		
Φ5	Φ45	8-		
Φ6	Φ50	10-		
Φ8	Φ60	10-		
Φ10	Φ70	10-		
Φ15	Φ80	10-		
Φ20	Φ100	10-		
Φ30	Φ100	10-		

WHEEL BRUSH

Introduction /use:

For Wheel Brush, the surface of the workpiece is ground and polished. The selected grinding machine and polishing material must be combined with the characteristics of the workpiece. The surface of the workpiece is ground and polished to meet the conditions of the workpiece of the grinding and polishing machine. After the variety of the grinding and polishing machine is determined, the type of polishing material can be used, that is, the positioning of the grinding medium. Suitable for rust removal, polishing, chamfering, deburring, grinding, and cleaning, etc. Cover different industries such as auto parts, mechanical



Wheel brush parameters

Inner chip diameter	Cover diameter	Overall diameter (D)	Brush diameter (L)	Optional brush material	Rotating speed
Φ6	Φ20	Φ30-Φ40	6-	Silicon carbide, alumina, nylon, copper-plated steel wire, brass wire, stainless steel wire, flame-retardant steel wire, etc	1800
Φ12	Φ33	Φ35-Φ60	6-		
Φ18	Φ36/Φ46	Φ65-Φ70	7-		
Φ27	Φ55/Φ60	Φ85-Φ100	8-		
Φ44	Φ70/Φ80	Φ115-Φ135	10-		
Φ53	Φ84/Φ103	Φ140-Φ150	11-		
Φ70	Φ115	Φ160-Φ200	10-		
Φ83	Φ120/Φ140	Φ180-Φ220	11-		
Φ103	Φ140/Φ160	Φ200-Φ250	12-		
Φ137	Φ200	Φ250-Φ300	12-		

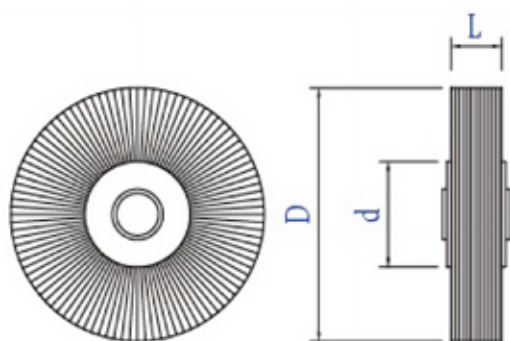

WHEEL BRUSH

Introduction /use:

Main categories include: wheel brush (Injection), wheel brush (Curled), wheel brush (Plantation), Mainly used for decarburization, rust removal, decontamination, de-welding, polishing, and deburring etc.

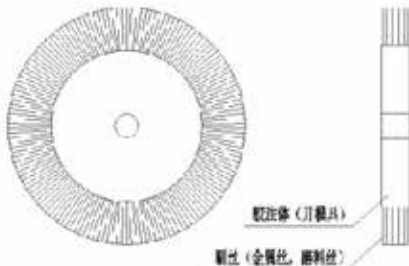

Wheel Brush parameter

Overall Diameter (D)	Inner Chip Diameter	Brush Length (L)	Optional brush material	Rotating speed
-	-	-	Steel wire, stainless steel wire, abrasive wire	1800

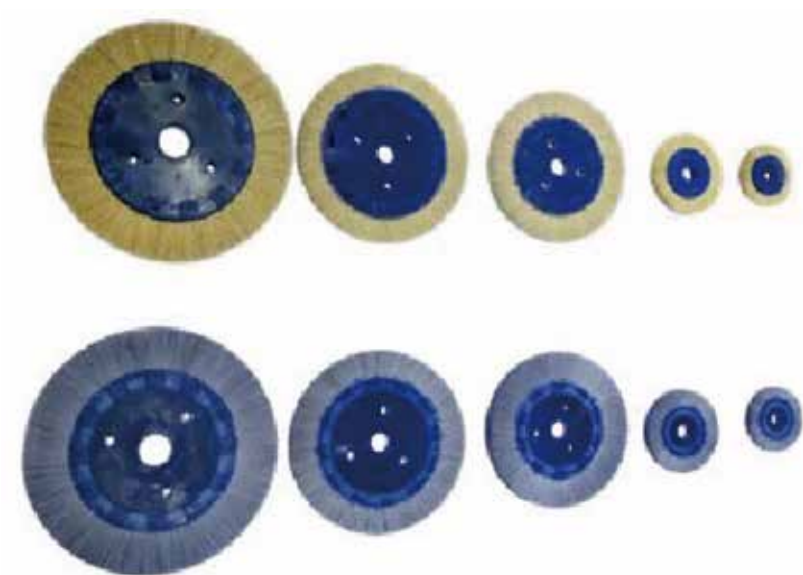



CONTACT US



+52 81 2944 7830
+52 81 3453 0513



ventas@gwtmetal.com
ventas.slp@gwtmetal.com



Global Working Tools
México,



You can count on us to support you with the optimization and cost reduction on your machining processes

